

# Oticon ♦ Corda<sup>2</sup>

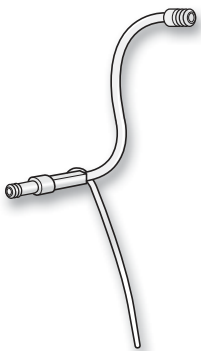

# The complete Corda<sup>2</sup> solution

## The Corda<sup>2</sup> Kit contains everything you need to get started:

- Left and right tubes in four lengths
- Three sizes of open Corda<sup>2</sup> domes
- Corda<sup>2</sup> Plus domes
- Measurement tool and cleaners
- Fitting Guide
- Adaptor for Vigo / Vigo Pro
- Adaptor for Syncro, Safran, Tego / Tego Pro and Go Pro
- Service tool and extra pins for adaptor / hook attachment

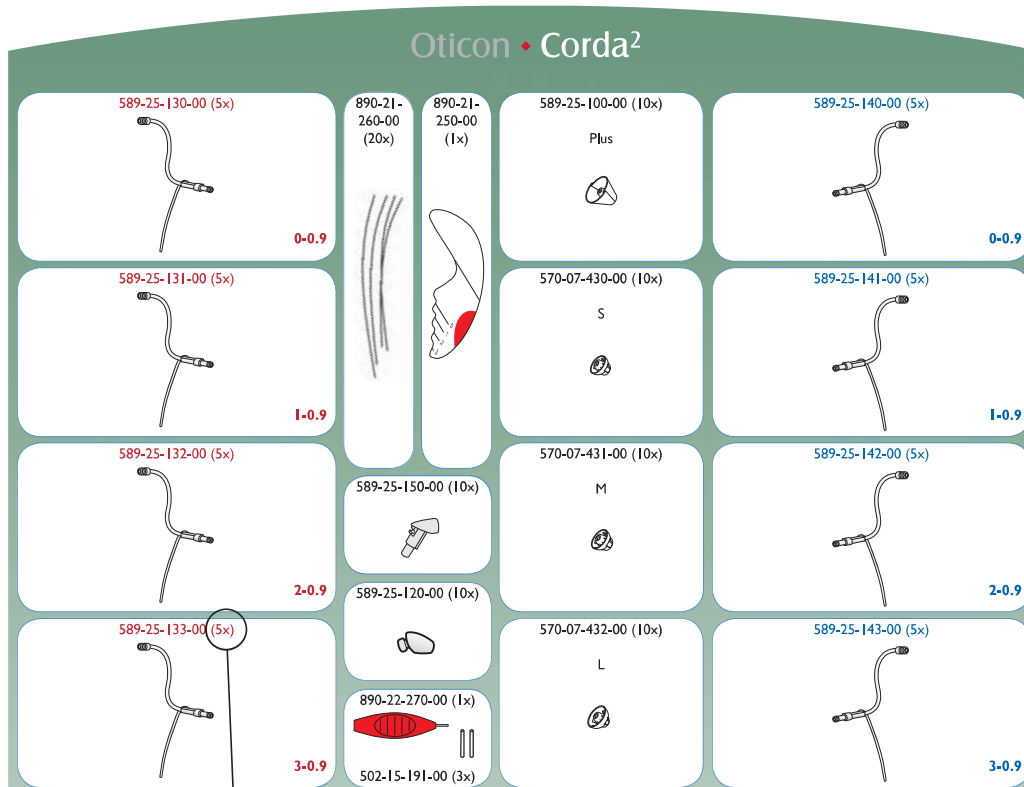

Please note that the number of items after the refill number – is the number of items in a refill pack – not the number of items in the Corda<sup>2</sup> box.

# Fitting information



Recommended Fitting range

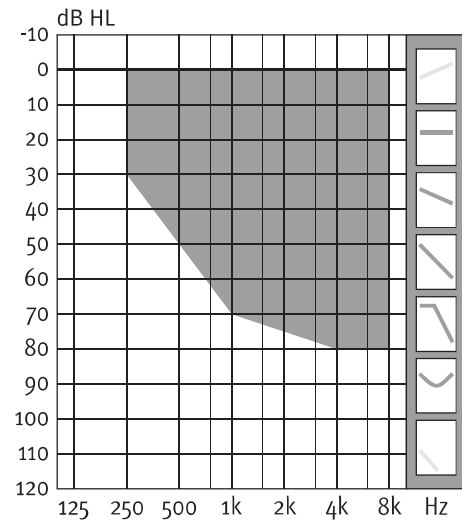

## Open fittings with Oticon Corda<sup>2</sup>

With Oticon Corda<sup>2</sup> you can offer your patient completely open fittings with the following Oticon BTE instruments:

- Vigo Pro
- Safran
- Go Pro
- Vigo
- Tego Pro
- Syncro
- Tego

Oticon Corda<sup>2</sup> can be fitted to all with a mild to moderate or high frequency (SKI-slope) hearing loss.

The unsurpassed efficiency of OpenEar Acoustics in combination with Corda<sup>2</sup> ensures a hassle-free fitting with high initial acceptance and a seamless patient experience:

- Discreet and cosmetically attractive
- No occlusion or feedback
- Comfortable and natural sound
- Excellent wearing comfort



# Fitting Corda<sup>2</sup>

## How to select the right tube and dome size

### Measurement tool

Use the measurement tool to define the length. Be sure the red side is facing you when measuring the right ear measurements and the blue side is facing you when measuring the left ear.

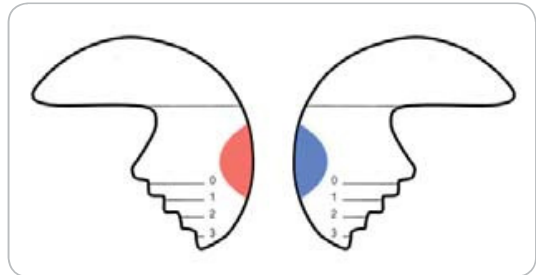

### Measuring the ear

The measurement must be made horizontally. Look straight into the client's ear.

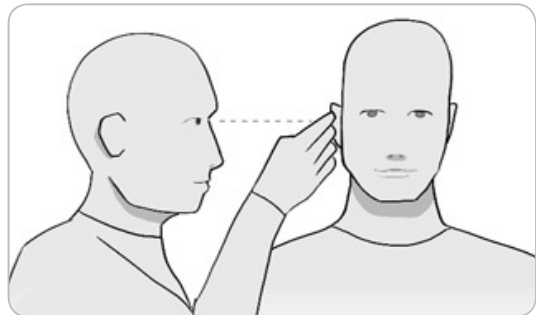

Hold the measurement tool horizontally with your thumb placed on the coloured area of the measurement tool. Choose the size that most closely aligns with an imaginary horizontal line across the top of the ear canal (dotted line). In the example shown, the correct choice is size 1.

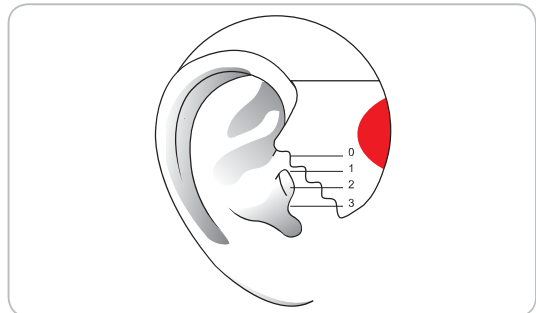

### Selecting dome size

Check the ear canal and choose between small, medium or large dome. The dome should stay in the ear canal without moving out while being worn, talking or chewing.

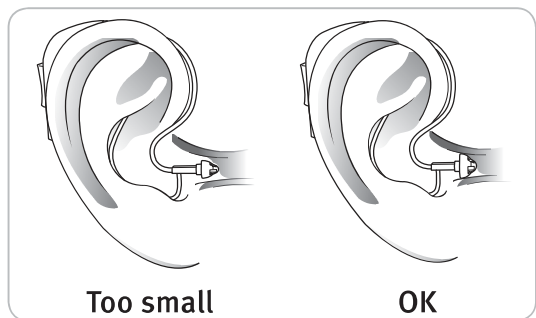

### Plus dome

When using the Plus dome, it is important that the small dome flap is facing up and placed inside the larger flap to provide the correct seal without occlusion.

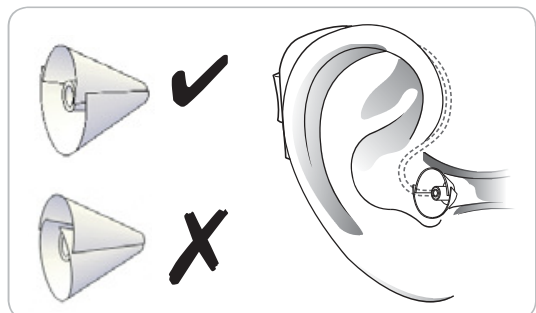

# Corda<sup>2</sup> with Vigo and Vigo Pro

## Substitute hook with Corda<sup>2</sup> solution

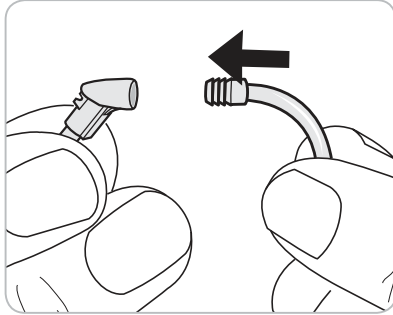

1. Attach the tube to adaptor.

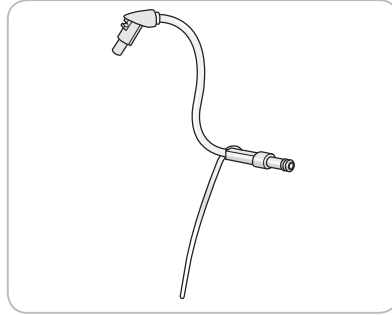

2. Adaptor and tube when attached.

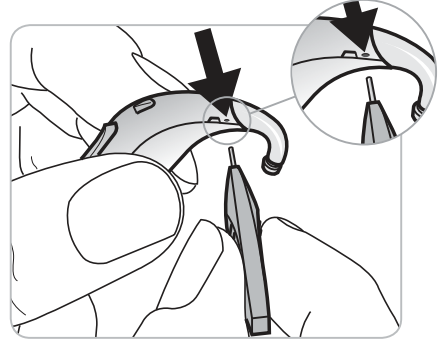

3. To remove the hook, insert the tip of the service tool as far as possible but do not push the pin all the way out. If you have difficulty in pushing the pin out, try from the other side of the hearing aid.

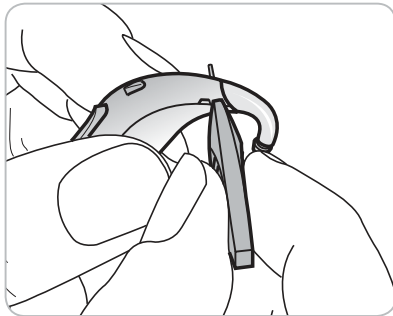

4. The pin should be left in position i.e. pushed through the hearing aid, yet still attached. Place the service tool in front of you.

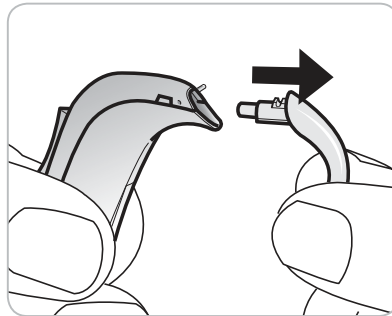

5. Pull the hook off.

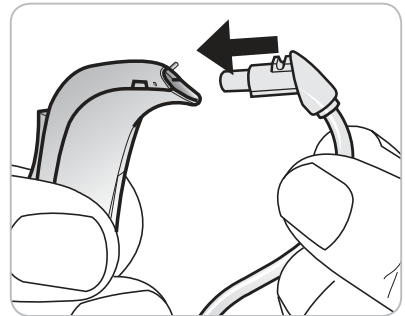

6. Insert the adaptor in the hearing aid. Make sure the adaptor is pushed in correctly.

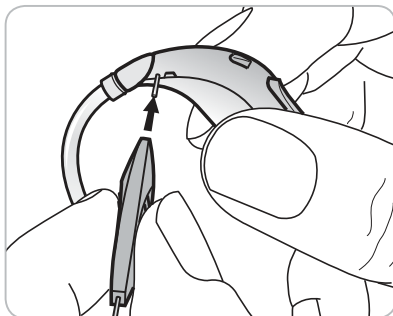

7a. Use the other end of the service tool and push the pin back into the hearing aid. Be sure to hold the service tool firmly on each side.

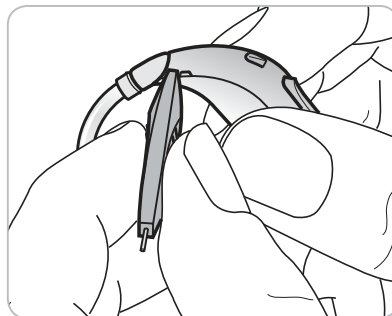

7b. Continue until the pin is flush with the hearing aid shell surface.

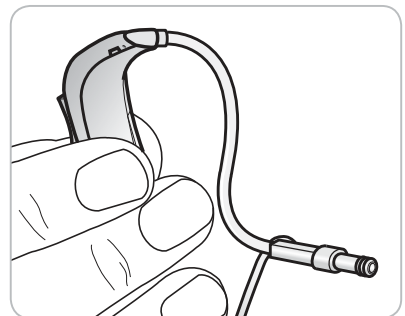

8. Now you have successfully attached the adaptor and Corda<sup>2</sup> tube!

# Corda<sup>2</sup> with Tego and Tego Pro

Substitute hook with Corda<sup>2</sup> on Syncro, Safran, Tego/Tego Pro and Go Pro

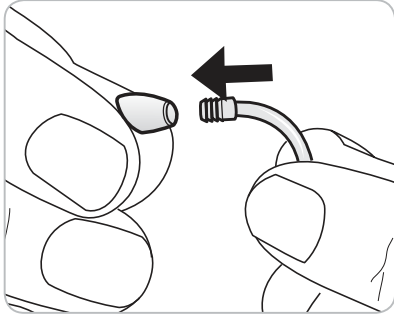

1. Attach the tube to adaptor.

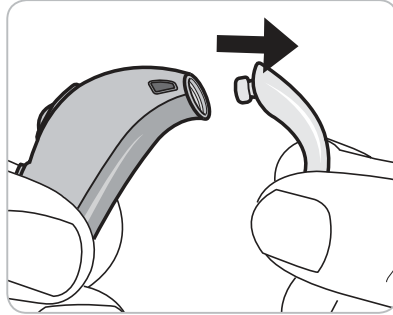

2. Snap the hook off the hearing aid.

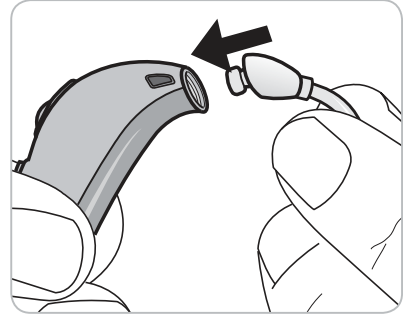

3. Click the adaptor on the hearing aid.

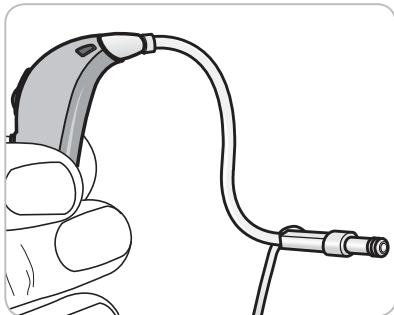

4. Now you have successfully attached the adaptor and Corda<sup>2</sup> tube!

## Positioning the hearing aid on the ear

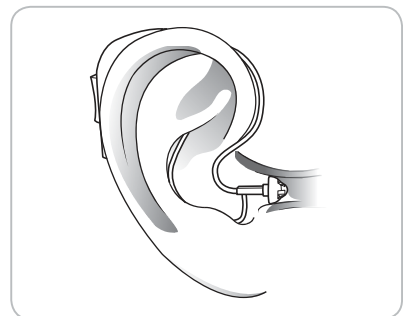
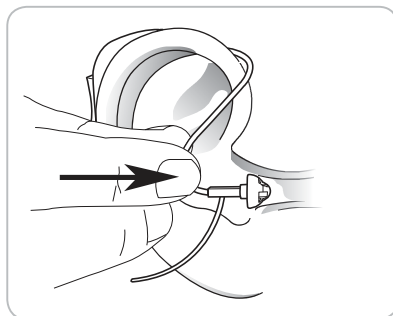
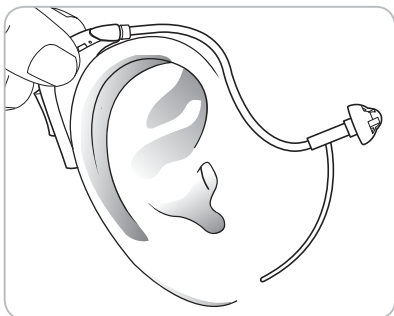

# Fitting Corda<sup>2</sup>

## Fitting Corda<sup>2</sup> in Genie

1. Enter client information and audiogram in NOAH and select Genie.
2. Detect or select the instrument in Genie.
3. Under Selected Instruments select Corda<sup>2</sup> instead of ear mold. If you are fitting Syncro, Safran, Tego, Tego Pro or Go Pro, select "yes" in the Corda<sup>2</sup> checkbox.
4. Go to the Fitting step and verify the correct dome – “Open dome” or “Plus dome”.
5. Complete the hearing aid fitting by following the normal procedure for finishing the Fitting and End Session steps.

## Fitting Corda<sup>2</sup> with custom molds

1. Select Corda<sup>2</sup> instead of earmold.
2. Go to the fitting step and verify the vent size of the custom mold. Select “Open dome” for an Open mold with 4 mm vent or “Plus dome” for a 3 mm vent.

## Warnings

- Only use parts designed for Oticon hearing aids.
- Corda and RITE domes are not interchangeable. If a RITE domes is selected it will not fit properly and may fall off in the ear.
- Domes should only ever be attached to a tube once. Always discard a dome after removing it from the tube.
- The cleaning tools should only be used for cleaning the tubing when it is detached from the hearing instrument and not on the ear.
- The dome must be properly attached to the sound tube before inserting it in your ear. Failure to follow the instructions could result in injury.
- If the dome is not correctly attached and falls off in the ear: Please see your hearing care professional or seek medical consultation.
- The tube should never be used without a dome attached.
- Ensure your hands are clean when handling the hearing instrument and its parts.
- Be careful when handling the service tool so it does not scratch the hearing aid.
- Service tool can only be used on Vigo/Vigo Pro.



**People First** We believe that it takes more than technology and audiology to create the best hearing instruments. That's why we put the individual needs and wishes of people with hearing loss first in our development of new hearing care solutions.